

N/F
PAUL G. HEFNER

TO N 83-53 E 100.5 TO

10' DRAINAGE EASEMENT

PWR

427

426

428

N 5-54 W 130.0

S 5-41 E 130.2

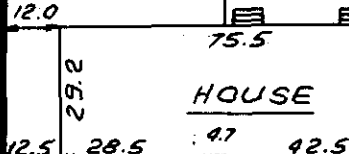

HOUSE

DRIVE

410.7' ± TO
GAVIN'S POINT ROAD

S 84-02 W 100.0

BRANSFIELD ROAD

FILED
GREENVILLE CO. S. C.
JUN 30 3 37 PM '86
JOHNNIE S. TANKERSLEY
R.M.C.

JUN 30 1986

44098 ✓ 12-W-97



NOTE: 5' DRAINAGE & UTILITY EASEMENT ALONG EACH SIDE OF ALL SIDE & REAR LOT LINES, UNLESS OTHERWISE SHOWN.

THIS IS TO CERTIFY THAT THE PROPERTY SHOWN ON THIS PLAT WAS SURVEYED UNDER MY DIRECT SUPERVISION. PROPERTY LINES AND IMPROVEMENTS SHOWN ARE LOCATED CORRECTLY AND THAT NO VISIBLE ENCROACHMENTS EXIST UNLESS OTHERWISE SHOWN. THIS PROPERTY IS NOT LOCATED IN A DESIGNATED FLOOD HAZARD AREA.

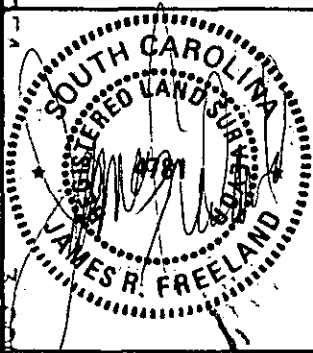

JLS JAMES R. FREELAND
NO. 4781

**STATE OF SOUTH CAROLINA
GREENVILLE COUNTY**

DEL NORTE ESTATES
SEC. 5, LOT 427
PROPERTY OF
JAMES V. LE CLAIRE
ROSJANE M. LE CLAIRE

**FREELAND-CLINKSCALES
& ASSOCIATES, INC.**

Engineers • Land Surveyors
323 WEST STONE AVENUE
GREENVILLE, S.C.
(803) 271-4924

PLAT BOOK	4 R-17
DEED BOOK	1130-258
TAX MAP	538.11-1-35
PARTY CHIEF	R.M.F.
DRAWN	I.R.
DATE	JUNE-23-86
DWG. NO.	15586